

RECONSTRUCTION AND STREETSCAPING MAIN STREET (MUSKOKA ROAD 3), HUNTSVILLE LORNE STREET TO MUSKOKA RIVER BRIDGE

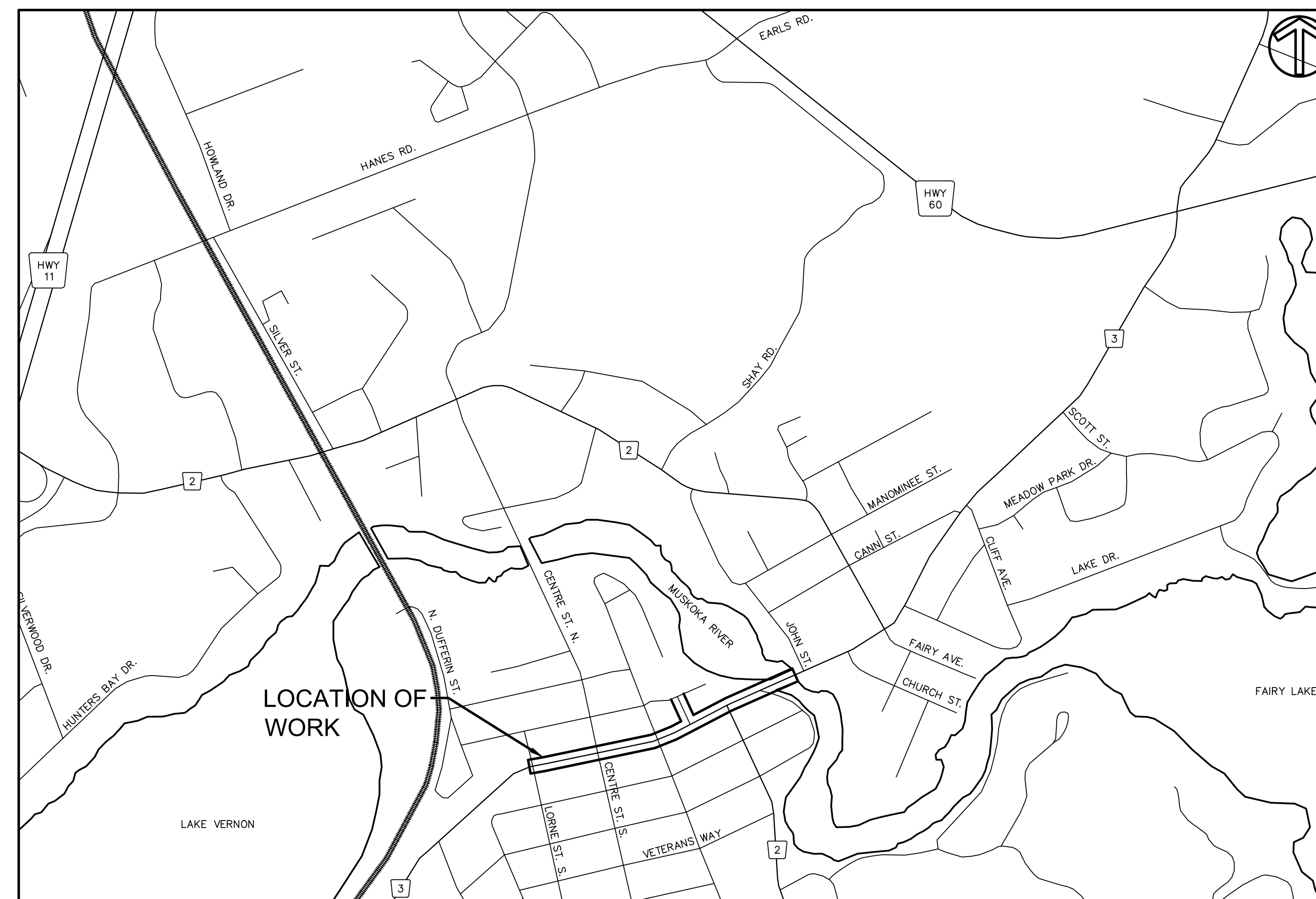

KEY PLAN

LANDSCAPE DRAWING LIST

- LKP - KENT PARK LAYOUT PLAN
- L101 - STREET TREE LAYOUT
STN 3+000 TO 3+260
- L102 - STREET TREE LAYOUT
STN 3+260 TO 3+580
- L103 - KING STREET LAYOUT PLAN
- L104 - LANDSCAPE DETAILS - 01
- L105 - LANDSCAPE DETAILS - 02

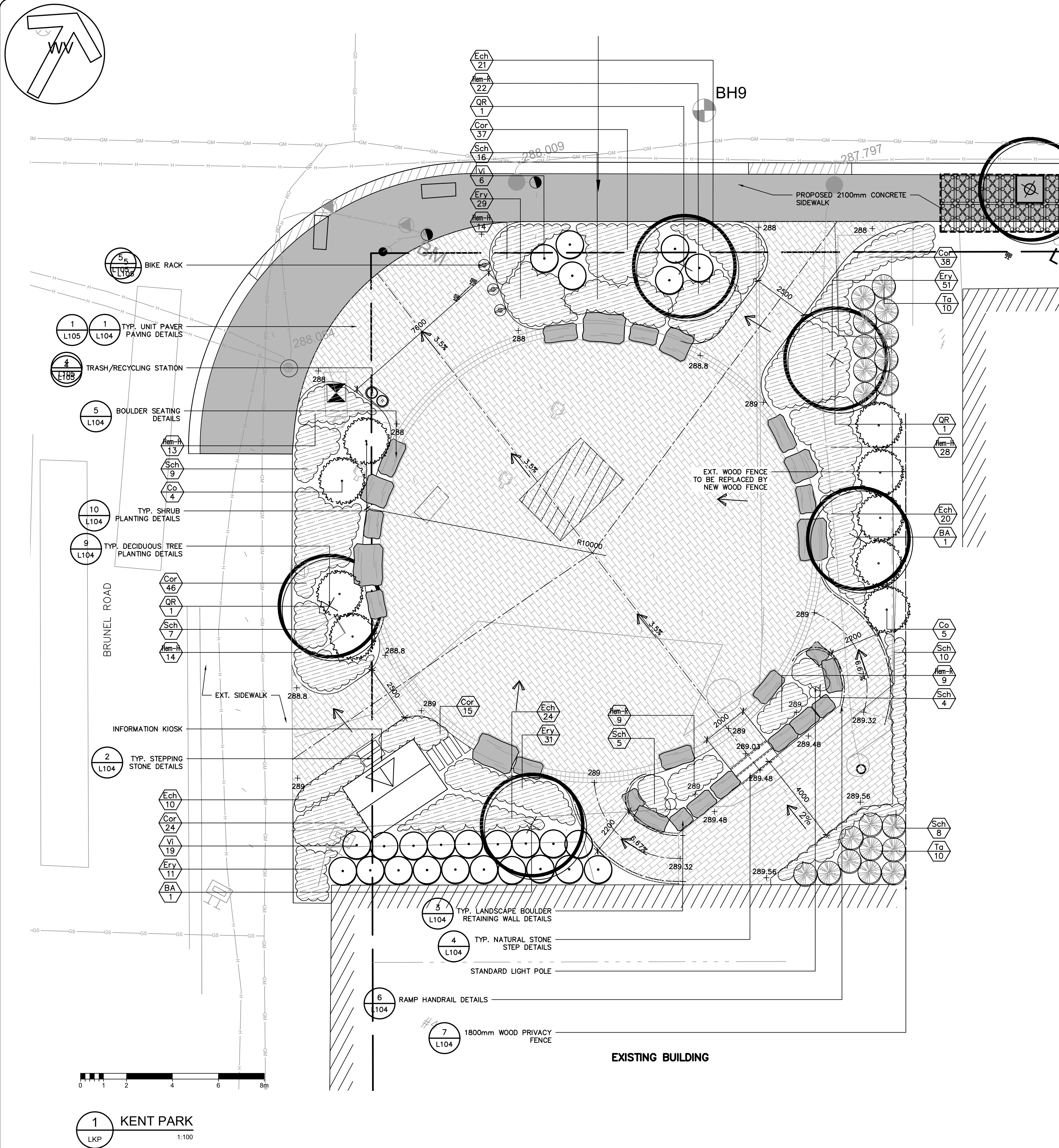

PLANTING NOTES

- ANY EXISTING TREES, UNLESS NOTED FOR REMOVAL, ARE TO BE PROTECTED FROM CONSTRUCTION DAMAGE WITH APPROVED FENCING. DO NOT ALTER GRADES OR COMPACT SOIL AROUND THE BASE OF AN EXISTING TREE. DO NOT DISTURB OR EXPOSE ROOTS OF ANY EXISTING TREE. REFER TO ARBORIST REPORT & TREE PROTECTION PLAN.
- TOPSOIL TO BE STOCKPILED SEPARATELY FROM SUBSOIL DURING EXCAVATION. IF TOPSOIL WILL BE STOCKPILED FOR MORE THAN 4 WEEKS, STOCKPILES WILL NOT EXCEED 2.5M IN HEIGHT TO ENSURE CONTINUED VIABILITY OF SOIL MICROORGANISMS.
- PLANT MATERIALS SPECIFIED FOR THIS PROJECT WILL CONFORM TO THE CANADIAN NURSERY TRADES ASSOCIATION (C.N.T.A.) FOR SIZE, VARIETY AND CONDITION AS INDICATED ON THE PLANT LIST SHOWN ON THESE DRAWINGS. ANY PLANT MATERIALS WHICH DO NOT CONFORM (IN THE OPINION OF THE LANDSCAPE ARCHITECT) WILL BE PROMPTLY REMOVED FROM THE SITE AND REPLACED BY THE CONTRACTOR AT NO ADDITIONAL COST TO THE PROJECT.
- PLANT MATERIALS COLLECTED FROM WILD SOURCES WILL NOT BE ACCEPTED. THE LANDSCAPE ARCHITECT RESERVES THE RIGHT TO REQUIRE THAT SUPPLIER INVOICES BE SUBMITTED FOR INSPECTION AND APPROVAL PRIOR TO ACCEPTANCE.
- THE LANDSCAPE ARCHITECT IS TO BE CONTACTED FOR INSPECTION AND WRITTEN APPROVAL PRIOR TO ANY PLANT MATERIAL INSTALLATION. ALL PLANT LOCATIONS TO BE STAKED AND CLEARLY LABELED FOR APPROVAL PRIOR TO PLANTING. THE LANDSCAPE ARCHITECT RESERVES THE RIGHT TO REJECT ANY PLANT MATERIALS THAT HAVE NOT BEEN INSPECTED AND APPROVED.
- THE LANDSCAPE ARCHITECT RESERVES THE RIGHT TO REFUSE ACCEPTANCE OF ANY PLANT DISPLAYING POOR GROWTH HABITS, INJURY OR DISEASE. ANY PLANT MATERIAL THAT IS REJECTED BY THE LANDSCAPE ARCHITECT WILL BE PROMPTLY REMOVED FROM THE SITE AND REPLACED WITH MATERIAL OF ACCEPTABLE QUALITY AT NO ADDITIONAL COST TO THE PROJECT.
- REMOVE DEAD OR DAMAGED BRANCHES ON TREES OR SHRUBS. ALL PRUNING SHALL BE PERFORMED IN ACCORDANCE WITH STANDARD HORTICULTURAL PRACTICES AND APPROPRIATE TIMING FOR EACH SPECIES.
- PLANTS ARE NOT TO BE INSTALLED OR TRANSPLANTED DURING EXTREME HEAT, DROUGHT OR OTHER UNDESIRABLE CONDITIONS. THOROUGHLY WATER ALL PLANT MATERIALS IMMEDIATELY AFTER INSTALLATION. CONTRACTOR NOT TO PROCEED IN UNCERTAINTY. CONTACT LANDSCAPE ARCHITECT FOR DIRECTION.
- THE CONTRACTOR IS TO RELOCATE ANY PROPOSED TREES OR SHRUBS ON THE SITE AS DIRECTED BY THE LANDSCAPE ARCHITECT.
- THE CONTRACTOR IS REQUIRED TO WATER PLANTS DURING CONSTRUCTION AND THE 2 YEARS WARRANTY PERIOD. PLANTS WILL BE WATERED WITHIN 48 HOURS OF WRITTEN REQUEST BY THE OWNER OR OWNER'S REPRESENTATIVE. FAILURE TO DO SO AFTER THE SECOND REQUEST SHALL RESULT IN WORK BEING UNDERTAKEN BY OTHERS. THE COST OF THIS WORK SHALL BE DEDUCTED FROM THE TOTAL CONTRACT PRICE OR HOLDBACK AND OTHERWISE RECOVERED FOR THE CONTRACTOR.
- ALL PLANTS ARE TO BE PLANTED IN ACCORDANCE WITH THE PLANTING DETAILS SHOWN IN THE DRAWINGS. REMOVE STAKES AND WIRES AT THE END OF WARRANTY PERIOD OR EARLIER, AS DIRECTED BY LANDSCAPE ARCHITECT.
- THE CONTRACTOR IS RESPONSIBLE FOR ALL MAINTENANCE & REPLACEMENT OF DEAD PLANT MATERIALS DURING THE WARRANTY PERIOD UNTIL FINAL ACCEPTANCE.
- THE LANDSCAPE ARCHITECT RESERVES THE RIGHT TO EXTEND THE CONTRACTOR'S WARRANTY RESPONSIBILITIES FOR AN ADDITIONAL YEAR IF, AT THE END OF THE INITIAL WARRANTY PERIOD LEAF DEVELOPMENT AND GROWTH IS NOT SUFFICIENT TO ENSURE FUTURE SURVIVAL AS DETERMINED BY THE LANDSCAPE ARCHITECT.
- GOOD QUALITY PLANTING SOIL SHOULD BE APPLIED TO ALL THE PLANTING AREA. REFER TO THE CITY'S STANDARDS SOIL SPECIFICATION ON DETAIL.
- PLACE A MINIMUM OF 100MM OF SHREDDED PINE-BARK MULCH OR EQUIVALENT MULCH ON ALL PLANTING BEDS AND MAINTAIN PLANTING BEDS WEED FREE.

PLANT SCHEDULE

Plant ID	Total Qty	Botanical Name	Common Name	CAL (mm)	HT (mm)	Root	Notes
DECIDUOUS TREES:							
BA*	2	<i>Betula alleghaniensis</i>	Yellow Birch	60		W.B.	
QR*	3	<i>Quercus rubra</i>	Red Oak	60		W.B.	
SHRUBS:							
Co*	9	<i>Cornus sericea</i>	Red Osier Dogwood			3 Gal.	2000mm O.C.
Ta*	20	<i>Taxus canadensis</i>	Canadian Yew		400	3 Gal.	1000mm O.C.
Vi*	25	<i>Viburnum acerifolium</i>	Mapleleaf Viburnum		500(spread)	3 Gal.	1200mm O.C.
PERENNIALS:							
Cor*	160	<i>Coreopsis lanceolata</i>	Lance-leaved Tickseed			1 Gal.	500mm O.C.
Ech*	75	<i>Echinacea purpurea</i>	Purple Cone Flower			1 Gal.	600mm O.C.
Ery	122	<i>Eryngium yabellii</i> 'Big Blue'	Big Blue Sea Holly			1 Gal.	500mm O.C.
Hem-H	69	<i>Hemerocallis</i> 'Happy Returns'	Happy Returns Daylily			1 Gal.	600mm O.C.
Hem-R	40	<i>Hemerocallis</i> 'Rosy Returns'	Rosy Returns Daylily			1 Gal.	600mm O.C.
Sch	51	<i>Schizachyrium scoparium</i> 'The Blues'	Little Bluestem			1 Gal.	700mm O.C.

* NATIVE SPECIES

EXP Services Inc.

Infrastructure Services - North Bay
757 Main St. East
North Bay, Ontario, Canada
P1B 1C1
Ph: 705 474 2728
Fax: 705 474 8515

www.exp.com



• BUILDINGS • EARTH & ENVIRONMENT • ENERGY •
• INDUSTRIAL • INFRASTRUCTURE • SUSTAINABILITY •

CAUTION: DO NOT SCALE DRAWINGS.

THIS REPRODUCTION MAY BE AT A SIZE DIFFERENT THAN ORIGINALLY DRAWN. EXP ASSUMES NO RESPONSIBILITY FOR INCORRECT SCALING. UNAUTHORIZED REPRODUCTION OR REUSE IS STRICTLY PROHIBITED. NOT PUBLISHED - ALL RIGHTS RESERVED. EXP EXPRESSLY DISCLAIMS RESPONSIBILITY ARISING FROM UNAUTHORIZED USE OF THESE DRAWINGS AND NOTES. AUTHORIZATION MUST BE IN WRITING.

© EXP, 2020

GENERAL NOTES:

- ALL DIMENSIONS ARE IN METERS (m) UNLESS NOTED OTHERWISE.
- CONTRACTOR TO VERIFY LOCATION AND SIZE OF ALL ABOVE AND BELOW GROUND UTILITIES AND SERVICES PRIOR TO CONSTRUCTION. UTILITIES SHOWN ON THESE DRAWINGS ARE APPROXIMATE ONLY. CONTRACTOR TO INFORM ENGINEER OF ANY DISCREPANCY.

PARTIAL LEGEND

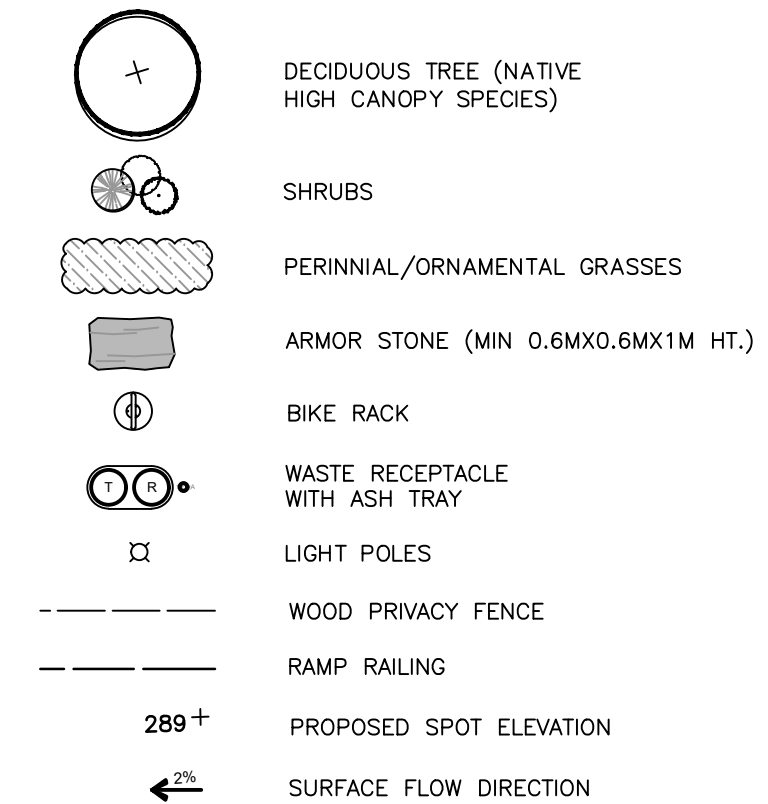

ISSUED FOR 60% DESIGN



Drawn By:	YM	Scale:	AS SHOWN
Checked By:	SW	Date:	
Approved By:	LR/SW	Date:	

Date Printed: August 7, 2020

File Name: NTB - 5252 - Landscape Plan

Project Title

RECONSTRUCTION OF MAIN STREET
(MUSKOKA ROAD 3)

Dwg. Title

KENT PARK
LANDSCAPE LAYOUT/
PLANTING PLAN

EXP Project No. NTB-00005252 DMM Contract No. 600-1-C-20

Dwg. No. LKP Rev. No. A

\\P\BFS001\NTB-Data\A\A-2019\INF Projects\NTB-00005252-00 Recon - Streetscaping Main St (Muskoka Road 3)\06 - Project Execution\0 - Design Drawings\Landscape

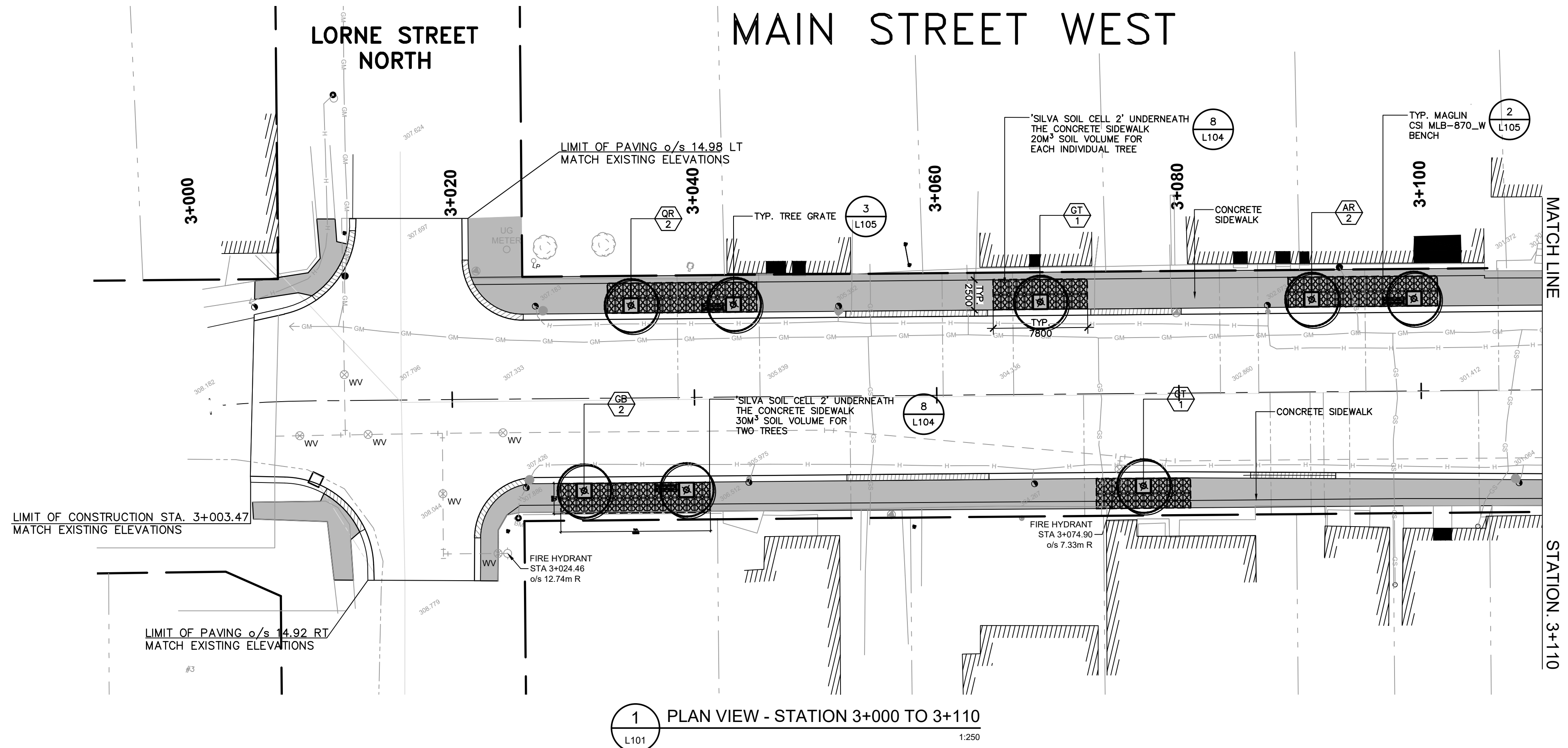
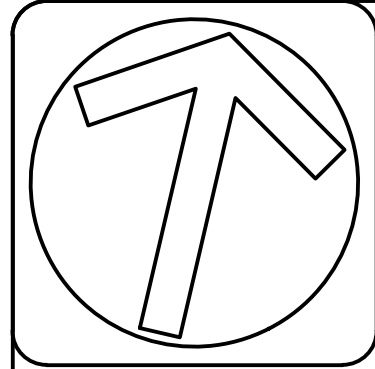

1 PLAN VIEW - STATION 3+000 TO 3+110
L101 1:250

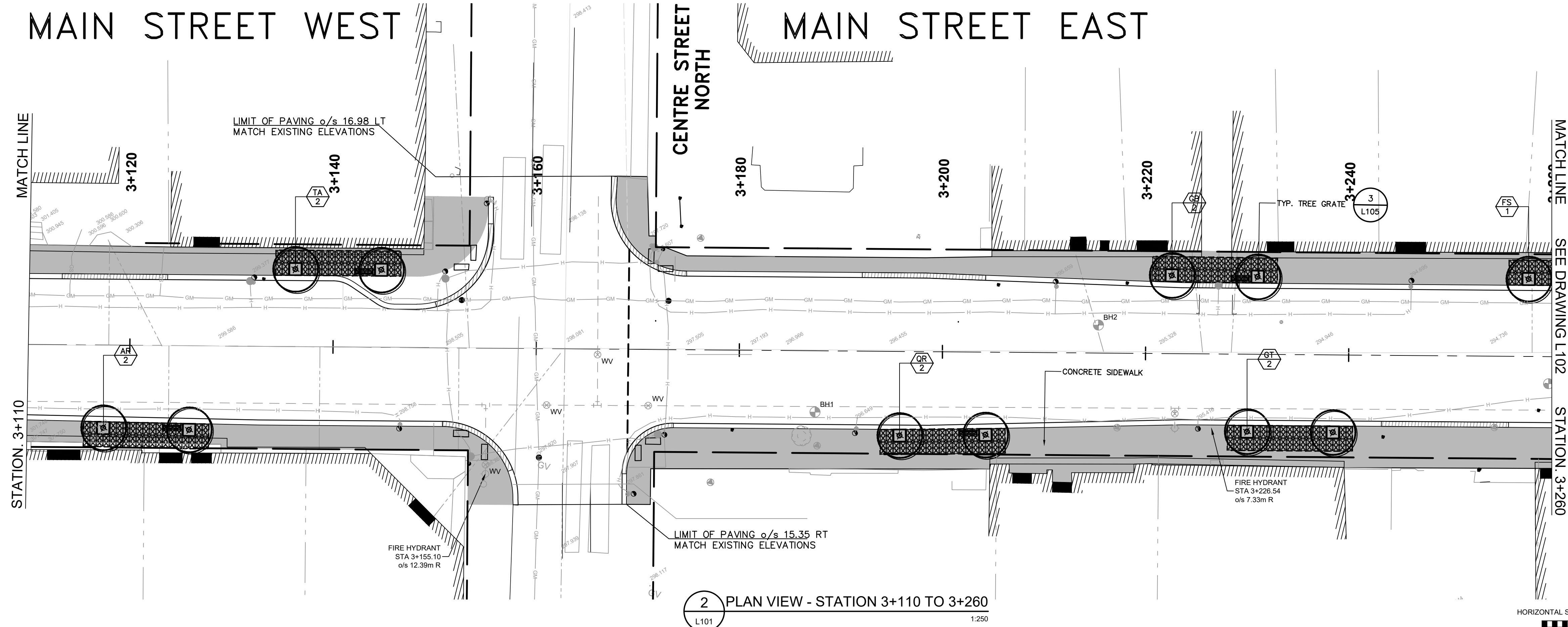
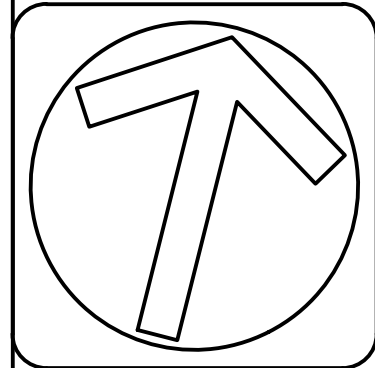

2 PLAN VIEW - STATION 3+110 TO 3+260
L101 1:250

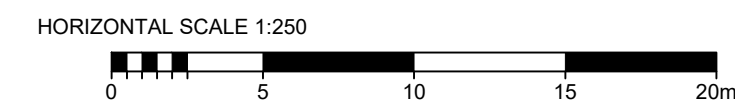

CAUTION: DO NOT SCALE DRAWINGS.
THIS REPRODUCTION MAY BE AT A SIZE DIFFERENT THAN ORIGINALLY DRAWN. EXP ASSUMES NO RESPONSIBILITY FOR INCORRECT SCALING. UNAUTHORIZED REPRODUCTION OR REUSE IS STRICTLY PROHIBITED. NOT PUBLISHED - ALL RIGHTS RESERVED. EXP EXPRESSLY DISCLAIMS RESPONSIBILITY ARISING FROM UNAUTHORIZED USE OF THESE DRAWINGS AND NOTES. AUTHORIZATION MUST BE IN WRITING.
© EXP, 2020

GENERAL NOTES:
1. ALL DIMENSIONS ARE IN METERS (m) UNLESS NOTED OTHERWISE.
2. CONTRACTOR TO VERIFY LOCATION AND SIZE OF ALL ABOVE AND BELOW GROUND UTILITIES AND SERVICES PRIOR TO CONSTRUCTION. UTILITIES SHOWN ON THESE DRAWINGS ARE APPROXIMATE ONLY. CONTRACTOR TO INFORM ENGINEER OF ANY DISCREPANCY.

PARTIAL LEGEND	
	PROPOSED SODDING
	PROPOSED UNIT PAVING
	PROPOSED CONCRETE SIDEWALK
	PROPOSED TREE W/ SOIL CELL
	PROPOSED SHRUB
	PROPOSED PERENNIAL
	PROPOSED CURB AND GUTTER
	PROPOSED DEPRESSED CURB AND GUTTER
	APPROXIMATE LIMIT OF RIGHT OF WAY
	EXISTING GAS MAIN
	EXISTING GAS SERVICE
	EX. HYDRO
	FUTURE AND NEW UNDERGROUND BELL
	EX. UNDERGROUND BELL
	DESIGNATED MARKET ZONES (0.60m WIDE)
	EXISTING / PROPOSED PUP CATCHBASIN
	EXISTING / PROPOSED CATCHBASIN MANHOLE
	EXISTING / PROPOSED SANITARY MANHOLE
	EXISTING LIGHT, UTILITY OR HYDRO POLE
	EXISTING / PROPOSED FIRE HYDRANT
	EXISTING / PROPOSED WATERMAIN VALVE
	EXISTING BUILDING
	EXISTING BUILDING ENTRANCE

No.	Revision	By	Date
A	ISSUED FOR 60% DESIGN	YM	JUL 28, 2020

ISSUED FOR 60% DESIGN			
Professional Seal	Professional Seal		
	Drawn By:	YM	Scale: AS SHOWN
	Checked By:	SW	Date:
	Approved By:	LR/SW	Date:
Date Printed: August 7, 2020			
File Name: NTB - 5252 - Landscape Plan			
Project Title			
RECONSTRUCTION OF MAIN STREET (MUSKOKA ROAD 3)			
Dwg. Title			
STATION 3+000 TO 3+260 STREET TREE LAYOUT			
EXP Project No.	DMM Contract No.		
NTB-00005252	600-1-C-20		
Dwg. No.	L101		Rev. No. A

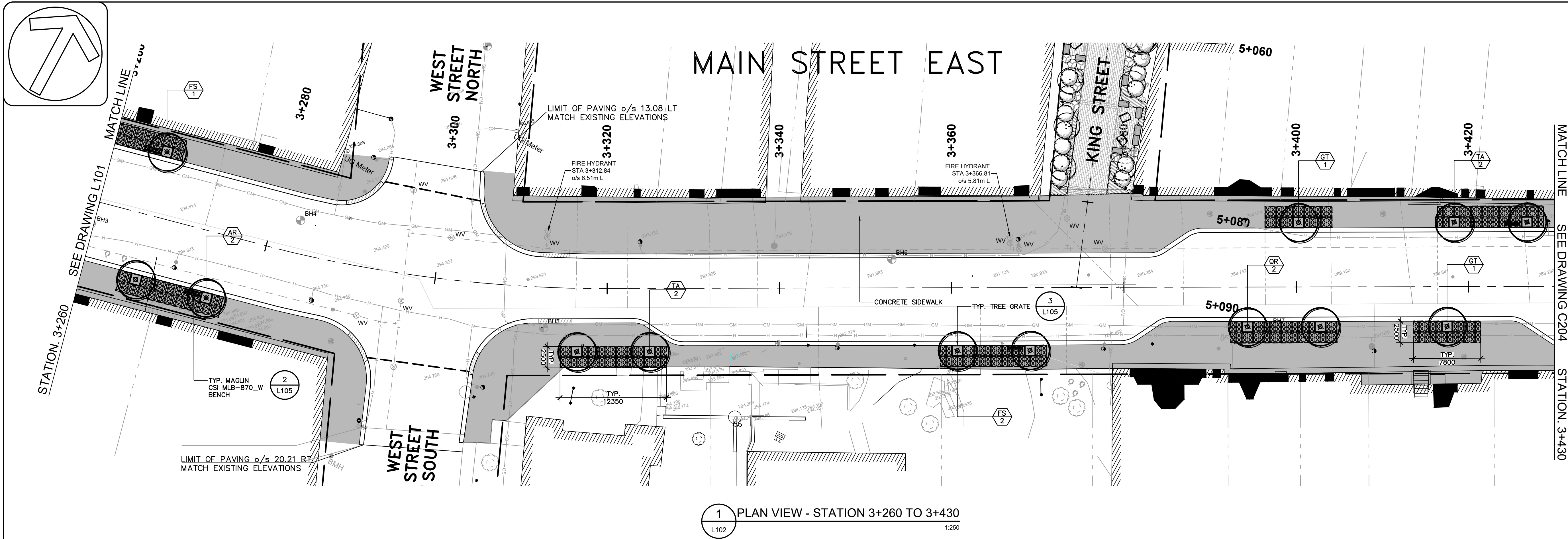

1 PLAN VIEW - STATION 3+260 TO 3+430
L102 1:250

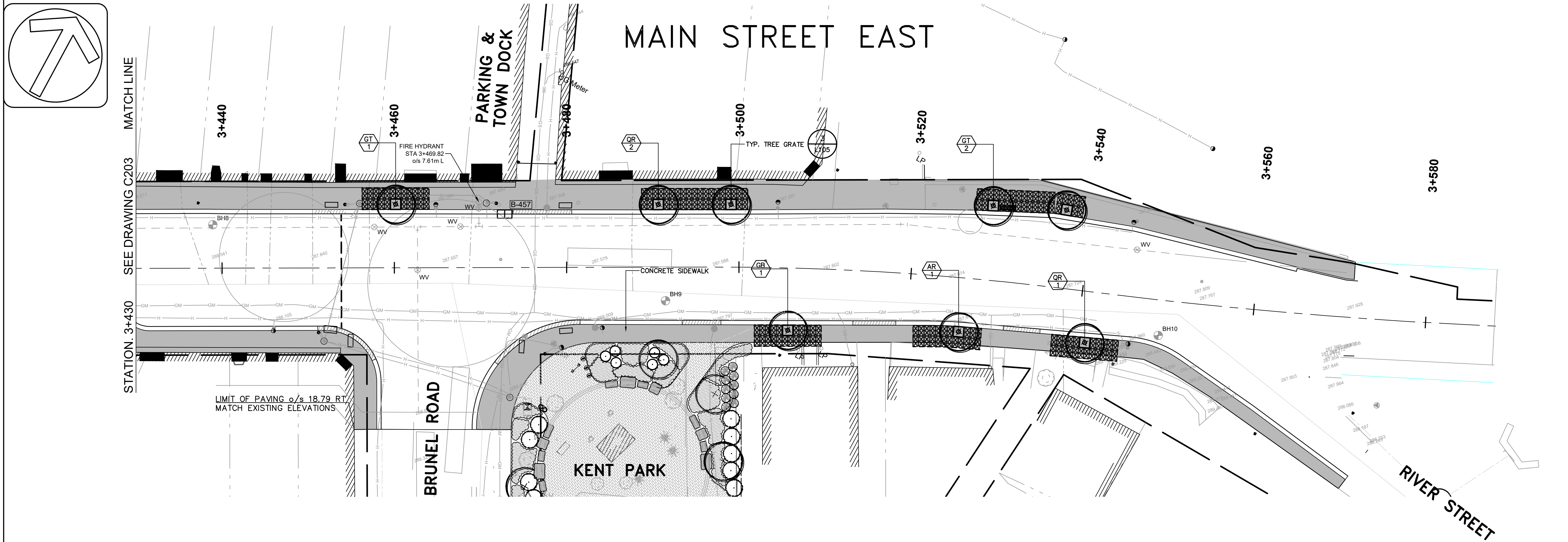

2 PLAN VIEW - STATION 3+430 TO 3+580
L102 1:250

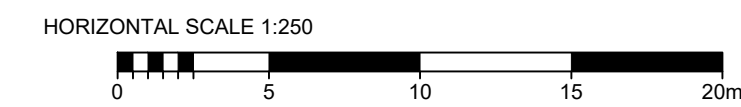

CAUTION: DO NOT SCALE DRAWINGS.

THIS REPRODUCTION MAY BE AT A SIZE DIFFERENT THAN ORIGINALLY DRAWN. EXP ASSUMES NO RESPONSIBILITY FOR INCORRECT SCALING. UNAUTHORIZED REPRODUCTION OR REUSE IS STRICTLY PROHIBITED. NOT PUBLISHED - ALL RIGHTS RESERVED. EXP EXPRESSLY DISCLAIMS RESPONSIBILITY ARISING FROM UNAUTHORIZED USE OF THESE DRAWINGS AND NOTES. AUTHORIZATION MUST BE IN WRITING.

© EXP, 2020

GENERAL NOTES:

1. ALL DIMENSIONS ARE IN METERS (m) UNLESS NOTED OTHERWISE.

2. CONTRACTOR TO VERIFY LOCATION AND SIZE OF ALL ABOVE AND BELOW GROUND UTILITIES AND SERVICES PRIOR TO CONSTRUCTION. UTILITIES SHOWN ON THESE DRAWINGS ARE APPROXIMATE ONLY. CONTRACTOR TO INFORM ENGINEER OF ANY DISCREPANCY.

PARTIAL LEGEND	
	PROPOSED SODDING
	PROPOSED UNIT PAVING
	PROPOSED CONCRETE SIDEWALK
	PROPOSED TREE W/ SOIL CELL
	PROPOSED SHRUB
	PROPOSED PERENNIAL
	PROPOSED CURB AND GUTTER
	PROPOSED DEPRESSED CURB AND GUTTER
	APPROXIMATE LIMIT OF RIGHT OF WAY
	EXISTING GAS MAIN
	EXISTING GAS SERVICE
	EX. HYDRO
	FUTURE AND NEW UNDERGROUND BELL
	EX. UNDERGROUND BELL
	DESIGNATED MARKET ZONES (0.60m WIDE)
	EXISTING / PROPOSED PUP CATCHBASIN
	EXISTING / PROPOSED CATCHBASIN MANHOLE
	EXISTING / PROPOSED SANITARY MANHOLE
	EXISTING LIGHT, UTILITY OR HYDRO POLE
	EXISTING / PROPOSED FIRE HYDRANT
	EXISTING / PROPOSED WATERMAIN VALVE
	EXISTING BUILDING
	EXISTING BUILDING ENTRANCE

A	ISSUED FOR 60% DESIGN	YM	JUL 28, 2020
No.	Revision	By	Date

ISSUED FOR 60% DESIGN	
Professional Seal 	Professional Seal
Drawn By: YM	Scale: AS SHOWN
Checked By: SW	Date:
Approved By: LR/SW	Date:
Date Printed: August 7, 2020	
File Name: NTB - 5252 - Landscape Plan	
Project Title	
RECONSTRUCTION OF MAIN STREET (MUSKOKA ROAD 3)	
Dwg. Title	
STATION 3+260 TO 3+580 STREET TREE LAYOUT	
EXP Project No. NTB-00005252	DMM Contract No. 600-1-C-20
Dwg. No. L102	Rev. No. A

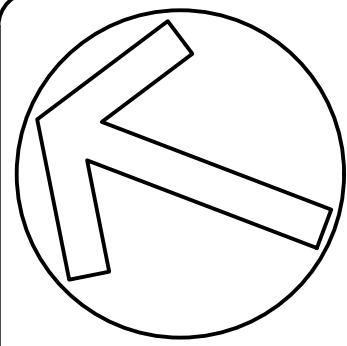

KING STREET

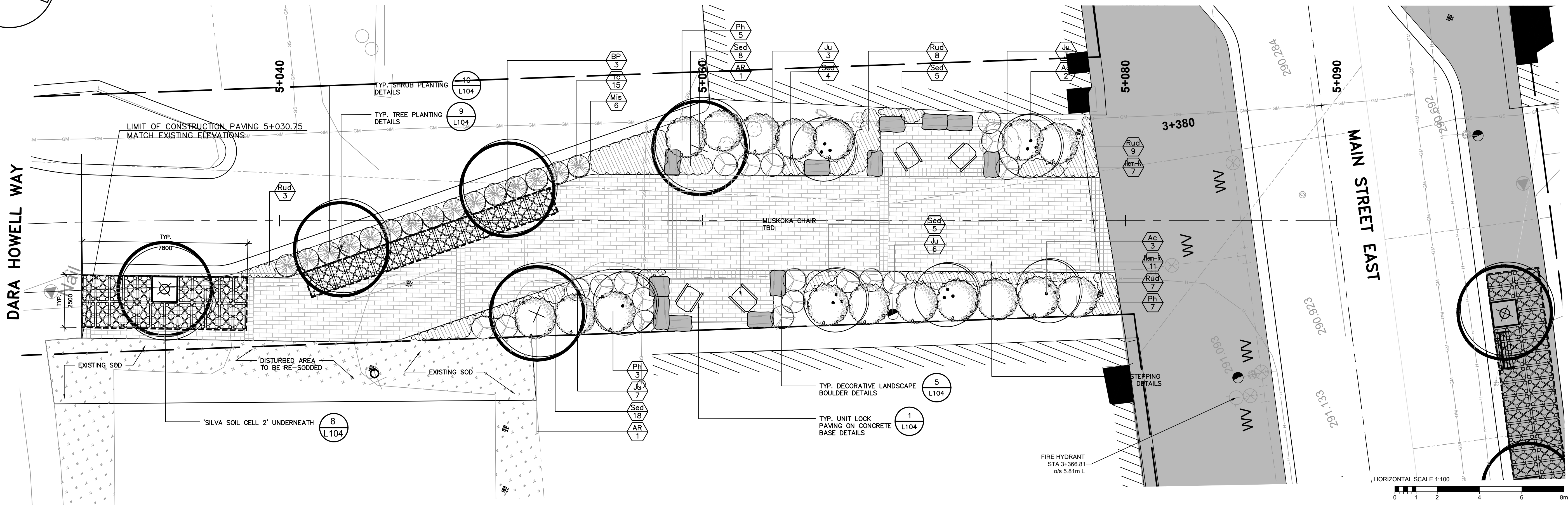

1 PLAN VIEW - STATION 5+020 TO 5+090
1:250

PLANTING NOTES

- ANY EXISTING TREES, UNLESS NOTED FOR REMOVAL, ARE TO BE PROTECTED FROM CONSTRUCTION DAMAGE WITH APPROVED FENCING. DO NOT ALTER GRADES OR COMPACT SOIL AROUND THE BASE OF AN EXISTING TREE. DO NOT DISTURB OR EXPOSE ROOTS OF ANY EXISTING TREE. REFER TO ARBORIST REPORT & TREE PROTECTION PLAN.
- TOPSOIL TO BE STOCKPILED SEPARATELY FROM SUBSOIL DURING EXCAVATION. IF TOPSOIL WILL BE STOCKPILED FOR MORE THAN 4 WEEKS, STOCKPILES WILL NOT EXCEED 2.5M IN HEIGHT TO ENSURE CONTINUED VIABILITY OF SOIL MICROORGANISMS.
- PLANT MATERIALS SPECIFIED FOR THIS PROJECT WILL CONFORM TO THE CANADIAN NURSERY TRADES ASSOCIATION (C.N.T.A.) FOR SIZE, VARIETY AND CONDITION AS INDICATED ON THE PLANT LIST SHOWN ON THESE DRAWINGS. ANY PLANT MATERIALS WHICH DO NOT CONFORM (IN THE OPINION OF THE LANDSCAPE ARCHITECT) WILL BE PROMPTLY REMOVED FROM THE SITE AND REPLACED BY THE CONTRACTOR AT NO ADDITIONAL COST TO THE PROJECT.
- PLANT MATERIALS COLLECTED FROM WILD SOURCES WILL NOT BE ACCEPTED. THE LANDSCAPE ARCHITECT RESERVES THE RIGHT TO REQUIRE THAT SUPPLIER INVOICES BE SUBMITTED FOR INSPECTION AND APPROVAL PRIOR TO ACCEPTANCE.
- THE LANDSCAPE ARCHITECT IS TO BE CONTACTED FOR INSPECTION AND WRITTEN APPROVAL PRIOR TO ANY PLANT MATERIAL INSTALLATION. ALL PLANT LOCATIONS TO BE STAKED AND CLEARLY LABELED FOR APPROVAL PRIOR TO PLANTING. THE LANDSCAPE ARCHITECT RESERVES THE RIGHT TO REJECT ANY PLANT MATERIALS THAT HAVE NOT BEEN INSPECTED AND APPROVED.
- THE LANDSCAPE ARCHITECT RESERVES THE RIGHT TO REFUSE ACCEPTANCE OF ANY PLANT DISPLAYING POOR GROWTH HABITS, INJURY OR DISEASE. ANY PLANT MATERIAL THAT IS REJECTED BY THE LANDSCAPE ARCHITECT WILL BE PROMPTLY REMOVED FROM THE SITE AND REPLACED WITH MATERIAL OF ACCEPTABLE QUALITY AT NO ADDITIONAL COST TO THE PROJECT.
- REMOVE DEAD OR DAMAGED BRANCHES ON TREES OR SHRUBS. ALL PRUNING SHALL BE PERFORMED IN ACCORDANCE WITH STANDARD HORTICULTURAL PRACTICES AND APPROPRIATE TIMING FOR EACH SPECIES.
- PLANTS ARE NOT TO BE INSTALLED OR TRANSPLANTED DURING EXTREME HEAT, DROUGHT OR OTHER UNDESIRABLE CONDITIONS. THOROUGHLY WATER ALL PLANT MATERIALS IMMEDIATELY AFTER INSTALLATION. CONTRACTOR NOT TO PROCEED IN UNCERTAINTY. CONTACT LANDSCAPE ARCHITECT FOR DIRECTION.
- THE CONTRACTOR IS TO RELOCATE ANY PROPOSED TREES OR SHRUBS ON THE SITE AS DIRECTED BY THE LANDSCAPE ARCHITECT.
- THE CONTRACTOR IS REQUIRED TO WATER PLANTS DURING CONSTRUCTION AND THE 2 YEARS WARRANTY PERIOD. PLANTS WILL BE WATERED WITHIN 48 HOURS OF WRITTEN REQUEST BY THE OWNER OR OWNER'S REPRESENTATIVE. FAILURE TO DO SO AFTER THE SECOND REQUEST SHALL RESULT IN WORK BEING UNDERTAKEN BY OTHERS. THE COST OF THIS WORK SHALL BE DEDUCTED FROM THE TOTAL CONTRACT PRICE OR HOLDBACK AND OTHERWISE RECOVERED FOR THE CONTRACTOR.
- ALL PLANTS ARE TO BE PLANTED IN ACCORDANCE WITH THE PLANTING DETAILS SHOWN IN THE DRAWINGS. REMOVE STAKES AND WIRES AT THE END OF WARRANTY PERIOD OR EARLIER, AS DIRECTED BY LANDSCAPE ARCHITECT.
- THE CONTRACTOR IS RESPONSIBLE FOR ALL MAINTENANCE & REPLACEMENT OF DEAD PLANT MATERIALS DURING THE WARRANTY PERIOD UNTIL FINAL ACCEPTANCE.
- THE LANDSCAPE ARCHITECT RESERVES THE RIGHT TO EXTEND THE CONTRACTOR'S WARRANTY RESPONSIBILITIES FOR AN ADDITIONAL YEAR IF, AT THE END OF THE INITIAL WARRANTY PERIOD LEAF DEVELOPMENT AND GROWTH IS NOT SUFFICIENT TO ENSURE FUTURE SURVIVAL AS DETERMINED BY THE LANDSCAPE ARCHITECT.
- GOOD QUALITY PLANTING SOIL SHOULD BE APPLIED TO ALL THE PLANTING AREA. REFER TO THE CITY'S STANDARDS SOIL SPECIFICATION ON DETAIL.
- PLACE A MINIMUM OF 100MM OF SHREDDED PINE-BARK MULCH OR EQUIVALENT MULCH ON ALL PLANTING BEDS AND MAINTAIN PLANTING BEDS WEED FREE.

SODDING NOTES

- SODDED AREAS AS SHOWN ON THE PLANTING PLAN ARE TO BE CERTIFIED CANADA NO. 1 CULTIVATED TURF SOD, WITH STRONG FIBROUS ROOT SYSTEM, THICK AND HEAVY GROWTH CONFORMING TO REQUIREMENTS OF NURSERY SOD GROWERS ASSOCIATION OF ONTARIO AND OF THE FOLLOWING MIX OR APPROVED EQUAL:
20% KENTUCKY BLUEGRASS
60% BLEND OF CREEPING RED FESCUE, CHEWING FESCUE, HARD FESCUE AND SHEEP FESCUE.
20% PERENNIAL RYEGRASS
USE LATEST APPROVED CULTIVARS OF GRASS IN ON AREAS TO BE SODDED SHALL HAVE A MINIMUM 150MM TOPSOIL BASE.
- LOOSEN SOIL SURFACE PRIOR TO SODDING. ELIMINATE BUMPS AND HOLLOW. ROLL LIGHTLY WHEREVER TOPSOIL IS EXCESSIVELY LOOSE.
- PRIOR TO SODDING, OBTAIN APPROVAL THAT FINISHED GRADE AND DEPTH AND COMPACTION RATES OF TOPSOIL ARE SATISFACTORY.
- DELIVER SOD TO SITE WITHIN 24 HOURS OF BEING LIFTED AND LAY WITHIN 36 HOURS OF BEING LIFTED. DURING DRY WEATHER PROTECT SOD FROM DRYING, AND WATER SOD AS NECESSARY TO ENSURE ITS VITALITY AND PREVENT THE LOSS OF SOIL IN HANDLING. DRY SOD WILL BE REJECTED.
- LAY SOD DURING GROWING SEASON. LAY SOD IN ROWS, PERPENDICULAR TO SLOPE, AND WITH JOINTS STAGGERED. BUTT SECTIONS CLOSELY WITHOUT OVERLAPPING OR LEAVING GAPS BETWEEN SECTIONS. CUT OUT IRREGULAR OR THIN SECTIONS WITH SHARP IMPLEMENTS.
- WATER SOD IMMEDIATELY AFTER LAYING TO OBTAIN MOISTURE PENETRATION INTO TOP 150MM OF TOPSOIL. MAINTAIN SODDED AREAS FROM START OF INSTALLATION UNTIL FINAL ACCEPTANCE.

PLANT SCHEDULE

Plant ID	Total Qty	Botanical Name	Common Name	CAL (mm)	HT (mm)	Root	Note
DECIDUOUS TREES:							
AR	9	<i>Acer rubrum</i> 'Red Sunset'	Red Sunset Maple	60		W.B	
BP*	3	<i>Betula papyrifera</i>	Paper Birch	60		W.B.	
FS	4	<i>Fagus sylvatica</i> 'Riversii'	River's Beech	60		W.B.	
GB	5	<i>Ginkgo biloba</i> 'Autumn Gold'	Autumn Gold Ginkgo	60		W.B	
GT	9	<i>Gleditsia Triacanthos</i> var. <i>Intermis</i> 'Shademaster'	Shademaster Honeylocust	60		W.B.	
OR*	9	<i>Quercus rubra</i>	Red Oak	60		W.B.	
TA*	6	<i>Tilia americana</i>	Basswood	60		W.B.	
SHRUBS:							
Ac*	5	<i>Amelanchier canadensis</i>	Serviceberry		1500	15 Gal	
Ju	19	<i>Juniperus communis</i> 'Green Carpet'	Green Carpet juniper	400 (spread)		3 Gal.	1300 O.C.
Ph*	15	<i>Physocarpus opulifolius</i>	Common Ninebark	500		3 Gal.	2000 O.C.
Tc*	15	<i>Taxus canadensis</i>	Canadian Yew	400 (spread)		3 Gal.	1000 O.C.
PERENNIALS:							
Hem	18	<i>Hemerocallis</i> 'Rosy Returns'	Rosy Returns Daylily			1 Gal.	500 O.C.
Mis	6	<i>Miscanthus sinensis</i> 'Sarabande'	Sarabande Maiden Grass			1 Gal.	600 O.C.
Rud	27	<i>Rudbeckia hirta</i>	Black Eyed Susan			1 Gal.	600 O.C.
Sed	40	<i>Sedum album</i>	Carpet Stonecrop			1 Gal.	500 O.C.

* NATIVE SPECIES

EXP Services Inc.

Infrastructure Services - North Bay
757 Main St. East
North Bay, Ontario, Canada
P1B 1C2
Ph: 705 474 2720
Fax: 705 474 4515

www.exp.com



• BUILDINGS • EARTH & ENVIRONMENT • ENERGY •
• INDUSTRIAL • INFRASTRUCTURE • SUSTAINABILITY •

CAUTION: DO NOT SCALE DRAWINGS.

THIS REPRODUCTION MAY BE AT A SIZE DIFFERENT THAN ORIGINALLY DRAWN. EXP ASSUMES NO RESPONSIBILITY FOR INCORRECT SCALING. UNAUTHORIZED REPRODUCTION OR REUSE IS STRICTLY PROHIBITED. NOT PUBLISHED - ALL RIGHTS RESERVED. EXP EXPRESSLY DISCLAIMS RESPONSIBILITY ARISING FROM UNAUTHORIZED USE OF THESE DRAWINGS AND NOTES. AUTHORIZATION MUST BE IN WRITING.
© EXP, 2020

GENERAL NOTES:

- ALL DIMENSIONS ARE IN METERS (m) UNLESS NOTED OTHERWISE.
- CONTRACTOR TO VERIFY LOCATION AND SIZE OF ALL ABOVE AND BELOW GROUND UTILITIES AND SERVICES PRIOR TO CONSTRUCTION. UTILITIES SHOWN ON THESE DRAWINGS ARE APPROXIMATE ONLY. CONTRACTOR TO INFORM ENGINEER OF ANY DISCREPANCY.

PARTIAL LEGEND

	PROPOSED SODDING
	PROPOSED UNIT PAVING
	PROPOSED CONCRETE SIDEWALK
	PROPOSED TREE W/ SOIL CELL
	PROPOSED SHRUB
	PROPOSED PERENNIAL
	PROPOSED CURB AND GUTTER
	PROPOSED DEPRESSED CURB AND GUTTER
	APPROXIMATE LIMIT OF RIGHT OF WAY
	EXISTING GAS MAIN
	EXISTING GAS SERVICE
	EX. HYDRO
	FUTURE AND NEW UNDERGROUND BELL
	EX. UNDERGROUND BELL
	DESIGNATED MARKET ZONES (0.60m WIDE)
	EXISTING / PROPOSED PUP CATCHBASIN
	EXISTING / PROPOSED CATCHBASIN MANHOLE
	EXISTING / PROPOSED SANITARY MANHOLE
	EXISTING LIGHT, UTILITY OR HYDRO POLE
	EXISTING / PROPOSED FIRE HYDRANT
	EXISTING / PROPOSED WATERMAIN VALVE
	EXISTING BUILDING
	EXISTING BUILDING ENTRANCE

ISSUED FOR 60% DESIGN

Professional Seal	Professional Seal
Drawn By: YM	Scale: AS SHOWN
Checked By: SW	Date:
Approved By: LR/SW	Date:
Date Printed: August 7, 2020	
File Name: NTB - 5252 - Landscape Plan	
Project Title	
RECONSTRUCTION OF MAIN STREET (MUSKOKA ROAD 3)	
Dwg. Title	
KING STREET STATION 5+020 TO 5+090 STREET TREE LAYOUT	
EXP Project No. NTB-00005252	DMM Contract No. 600-1-C-20
Dwg. No. L103	Rev. No. A

\\NTB\FS001\NTB-Data\A\A-2019\INF Projects\NTB-00005252-00 Recon - Streetscaping Main St (Muskoka Road 3)\0 - Project Execution\0 - Design Drawings\Landscape

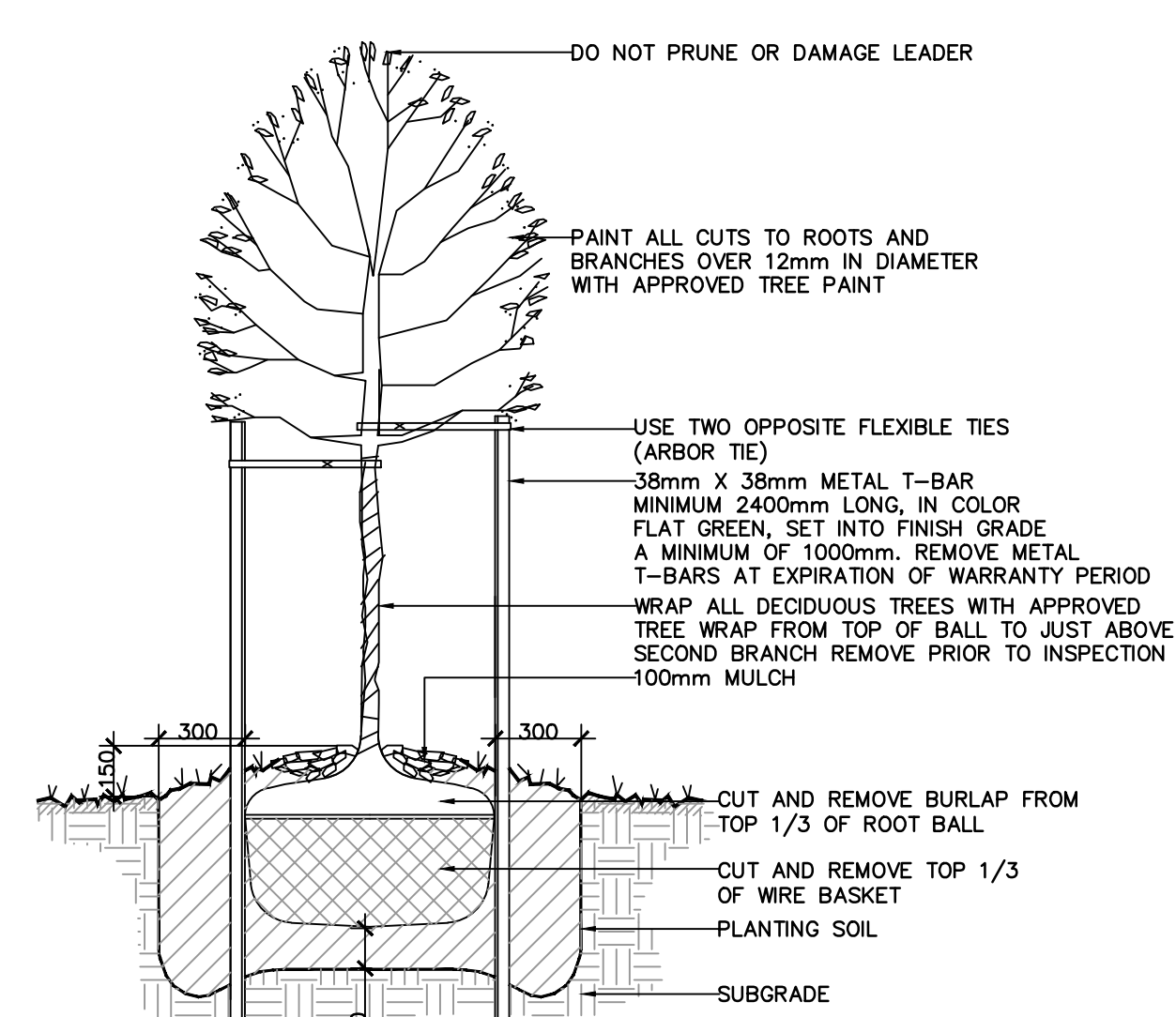
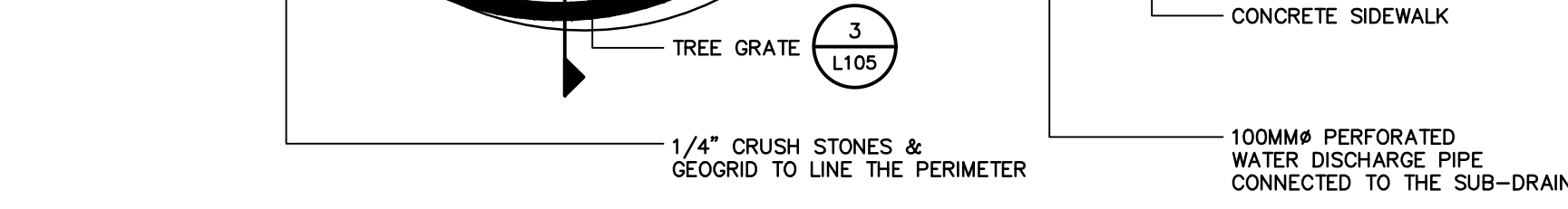
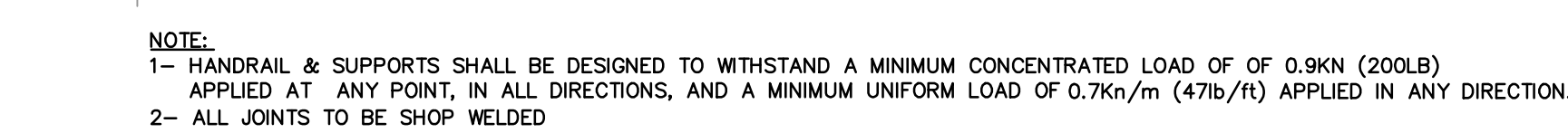

A	ISSUED FOR 60% DESIGN	YM	JUL 28, 202
No.	Revision	By:	Date

Dwg. No.	Rev. No.
L104	A

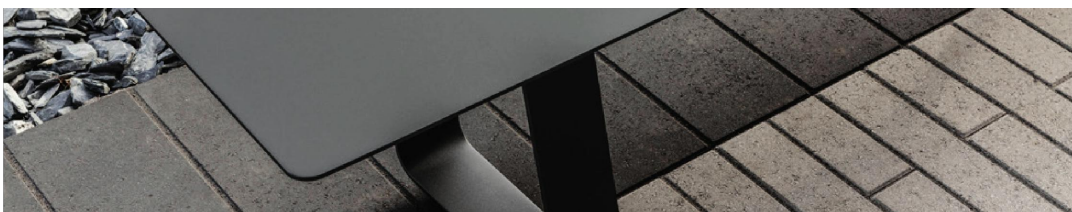

INDUSTRIA 200 SERIES

DESCRIPTION: Paver TEXTURE: HD[®] Smooth or HD[®] Granitex

PALLET OVERVIEW - 200x200

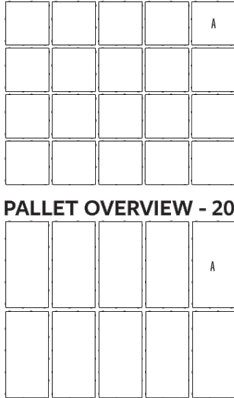

NOTES

See page 48 to 51 for more technical information.
All 200 series items are on order only.
Minimum order required: 500 ft².

Specifications per pallet		Imperial	Metric
200x200	Cubing	60.28 ft ²	5.60 m ²
	Approx. Weight	2 863 lbs	1 299 kg
	Number of rows	7	
	Coverage per row	8.61 ft ²	0.80 m ²
	Linear coverage per row	13.12 lin. ft	4 lin. m

Unit dimensions		in	mm	Units/pallet
200x200	Height	3 1/4"	100	140 units
	Width	7 3/4"	200	
	Length	7 3/4"	200	

Specifications per pallet		Imperial	Metric
200x200	Cubing	60.28 ft ²	5.60 m ²
	Approx. Weight	2 862 lbs	1 298 kg
	Number of rows	7	
	Coverage per row	8.61 ft ²	0.80 m ²
	Linear coverage per row	13.12 lin. ft	4 lin. m

Unit dimensions		in	mm	Units/pallet
200x200	Height	3 1/4"	100	70 units
	Width	7 3/4"	200	
	Length	15 3/4"	400	

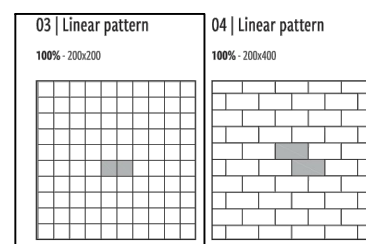
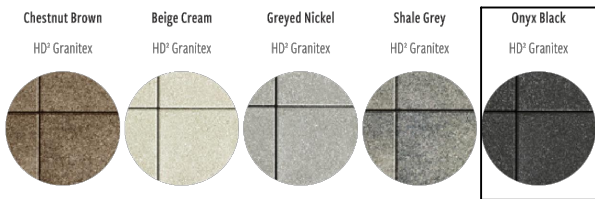
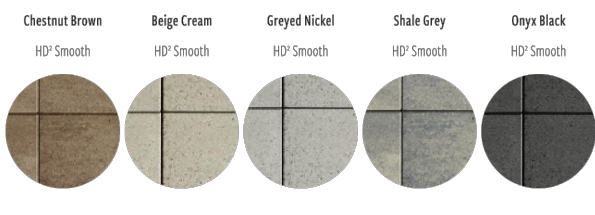

Patterns are for design inspiration only. The installer is responsible to calculate & purchase the correct amount of material.

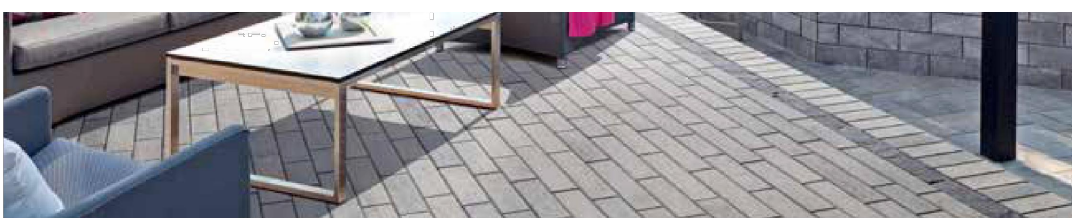

LINEA LARGE RECTANGLES

DESCRIPTION: Paver TEXTURE: Smooth

PALLET OVERVIEW

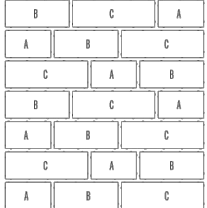

NOTES

See page 44 to 47 for more technical information.

Specifications per pallet		Imperial	Metric
200x200	Cubing	77.14 ft ²	7.17 m ²
	Approx. Weight	3 631 lbs	1 647 kg
	Number of rows	7	
	Coverage per row	11.02 ft ²	1.02 m ²
	Linear coverage per row	22.40 lin. ft	6.83 lin. m

Unit dimensions		in	mm	Units/pallet
200x200	Height	3 1/4"	100	49 units
	Width	5 7/8"	150	
	Length	8 7/8"	225	

Unit dimensions		in	mm	Units/pallet
200x200	Height	3 1/4"	100	49 units
	Width	5 7/8"	150	
	Length	12 1/4"	325	

Unit dimensions		in	mm	Units/pallet
200x200	Height	3 1/4"	100	49 units
	Width	5 7/8"	150	
	Length	16 3/4"	425	

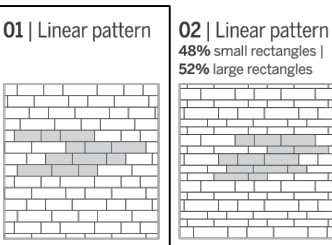

Patterns are for design inspiration only. The installer is responsible to calculate & purchase the correct amount of material.



1

UNIT PAVER

NTS

870 SERIES

MLB870-W



MATERIALS: Bench ends are made from solid cast aluminum. The seat employs ipe wood slats.

FINISH: All steel components are protected with E-Coat rust proofing. The Maglin Powdercoat System provides a durable finish on all metal surfaces.

INSTALLATION: The bench is delivered pre-assembled. Holes (0.5") are provided in each foot for securing to base.

TO SPECIFY: Select MLB870-W
Choose:
- Powdercoat Color

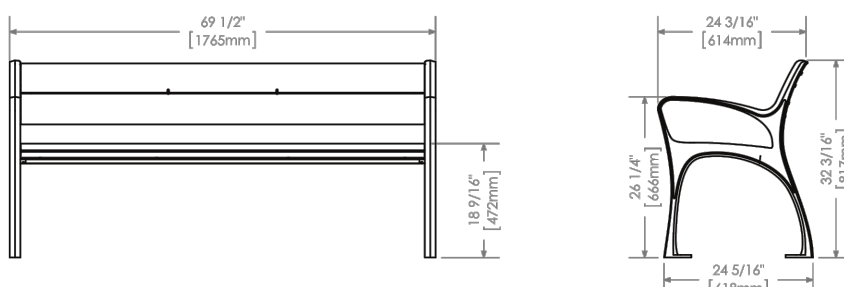

DIMENSIONS:
Height: 32.2" (82.7cm)
Length: 69.5" (176.5cm)
Depth: 24.5" (61.9cm)
Weight: 121.62lbs (55.1kg)



All drawings, specifications, design and details on this page remain the property of Maglin Site Furniture Inc. and may not be used without Maglin authorization.
Details and specifications may vary due to continuing improvements of our products.

T: 800-716-5506
F: 877-850-9363
WWW.MAGLIN.COM
SALES@MAGLIN.COM

2
L105

MAGLIN MLB870-W BENCH

NTS

8954 PLAZA Set

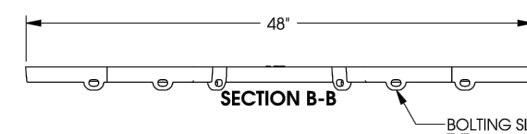
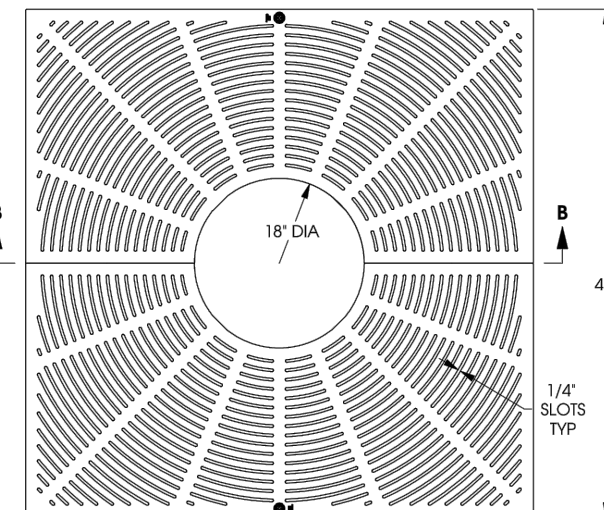

Product Number
8954-01CH
Design Features
-Aluminum
-Powder Coat
-Grey Iron (E1388)

Design Load
Non-Traffic
4110 lbs./Inches
Capacity
Unloaded
-/- Designated Matched Surface

Certification
ASTM A48
-/-
Country of Origin: USA
Major Components
8954-01CH

Drawing Revision
11/03/03 Designer: DEW
09/02/03 Revised by: GJH

Disclaimer
EJW warrants that the drawings and specifications are true and correct as of the date of issue. EJW does not warrant the drawings and specifications for any other purpose. EJW does not warrant the drawings and specifications for any other purpose. EJW does not warrant the drawings and specifications for any other purpose.

Contact
800-825-4653
ejw.com

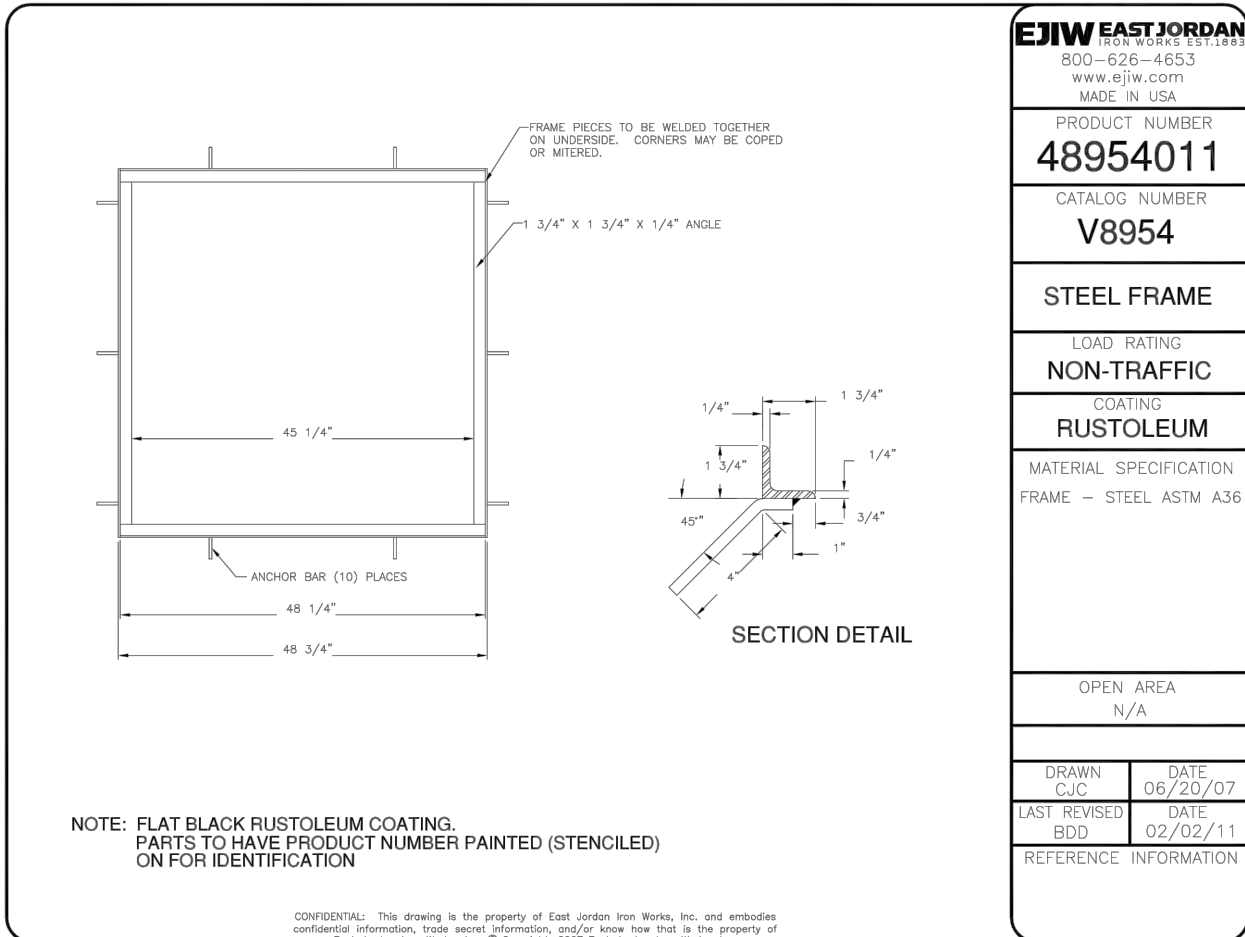

NOTE: FLAT BLACK RUSTOLEUM COATING.
PARTS TO HAVE PRODUCT NUMBER PAINTED (STENCILED)
ON FOR IDENTIFICATION

CONFIDENTIAL: This drawing is the property of East Jordan Iron Works, Inc. and contains confidential information. No part of this drawing may be reproduced or transmitted in any form or by any means electronic or mechanical, including photocopying, recording, or by any information storage and retrieval system, without the prior written permission of East Jordan Iron Works, Inc. © Copyright 2007 East Jordan Iron Works, Inc.

3
L105

TREE GRATE

NTS



MAGLIN™

RECYCLING STATIONS

T: 800-716-5506
F: 877-850-9363
WWW.MAGLIN.COM
SALES@MAGLIN.COM

MRC252-ST

MATERIALS: The recycling station frame is constructed using heavy duty steel flatbar. 2 - 20 gallon commercial grade plastic liners and black molded plastic lid are provided.

FINISH: All steel components are protected with E-Coat rust proofing. The Maglin Powdercoat System provides a durable finish on all metal surfaces.

INSTALLATION: The recycling station is delivered pre-assembled. Holes (0.5") are provided in each mounting foot for securing to base.

TO SPECIFY: Select MRC252
Choose:
- Powdercoat Color
- Standard Lid (SL) or lid options shown below
- Recycle Labels
- Spun Metal Lids
- Trash Opening (MTO)
- Bottle/Can Lid (MBC)
- Paper Slot Lid (MPS)



*also available in 3 unit configuration - MRC253

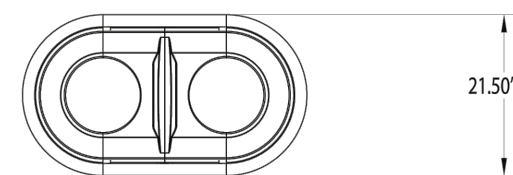

DIMENSIONS:
Height: 35.875" (91.1 cm)
Width: 21.50" (54.6 cm)
Depth: 38.00" (96.5 cm)
Weight: 250lbs (113kg)
Liner Capacity: 2 x 20.0 Gallons
(each) 2 x 75.7 Litres

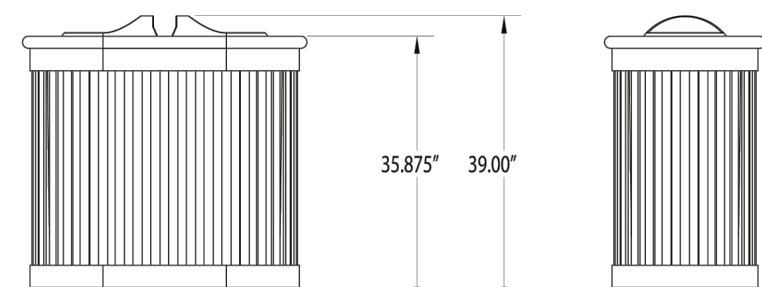

All drawings, specifications, design and details on this page remain the property of Maglin Site Furniture Inc. and may not be used without Maglin authorization.
Details and specifications may vary due to continuing improvements of our products.

Maglin is a registered trade mark of Maglin Site Furniture Inc.

4
L105

TRASH/RECYCLING STATION

NTS

MBR100-S

100 SERIES



MATERIALS: The bike rack is constructed using H.S. steel tube and an aluminum top casting.

FINISH: All steel components are protected with E-Coat rust proofing. The Maglin Powdercoat System provides a durable finish on all metal surfaces.

INSTALLATION: The bike rack is delivered pre-assembled.

TO SPECIFY: Select MBR100-S
Choose:
- Powdercoat Color
- Galvanized Finish
- Surface Mount (MBR100-S-G)

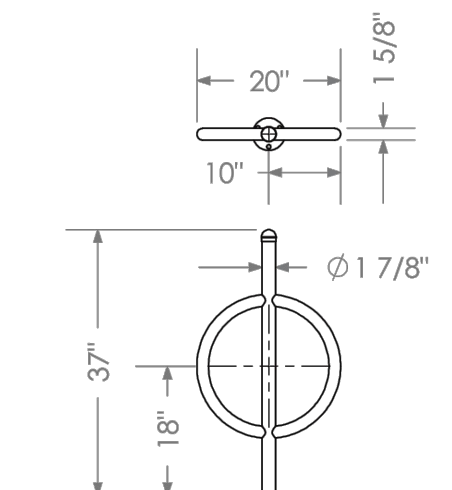

DIMENSIONS:
Height: 37" (94cm)
Width: 20" (50.8cm)
Weight: 14.48lbs (6.6kg)



All drawings, specifications, design and details on this page remain the property of Maglin Site Furniture Inc. and may not be used without Maglin authorization.
Details and specifications may vary due to continuing improvements of our products.

5
L105

BIKE RACK

NTS

EXP Services Inc.

Infrastructure Services - North Bay
757 Main St. East
North Bay, Ontario, Canada
P1B 1C2
Ph: 705-474-2728
Fax: 705-474-8515

www.exp.com



• BUILDINGS • EARTH & ENVIRONMENT • ENERGY •
• INDUSTRIAL • INFRASTRUCTURE • SUSTAINABILITY •

CAUTION: DO NOT SCALE DRAWINGS.

THIS REPRODUCTION MAY BE AT A SIZE DIFFERENT THAN ORIGINALLY DRAWN. EXP ASSUMES NO RESPONSIBILITY FOR INCORRECT SCALING. UNAUTHORIZED REPRODUCTION OR REUSE IS STRICTLY PROHIBITED. NOT PUBLISHED - ALL RIGHTS RESERVED. EXP EXPRESSLY DISCLAIMS RESPONSIBILITY ARISING FROM UNAUTHORIZED USE OF THESE DRAWINGS AND NOTES. AUTHORIZATION MUST BE IN WRITING.

© EXP, 2020

GENERAL NOTES:

1. ALL DIMENSIONS ARE IN METERS (m) UNLESS NOTED OTHERWISE.
2. CONTRACTOR TO VERIFY LOCATION AND SIZE OF ALL ABOVE AND BELOW GROUND UTILITIES AND SERVICES PRIOR TO CONSTRUCTION. UTILITIES SHOWN ON THESE DRAWINGS ARE APPROXIMATE ONLY. CONTRACTOR TO INFORM ENGINEER OF ANY DISCREPANCY.

A	ISSUED FOR 60% DESIGN	YM	JUL 28, 2020
No.	Revision	By:	Date

ISSUED FOR 60% DESIGN

Professional Seal	Professional Seal
Drawn By: YM	Scale: AS SHOWN
Checked By: SW	Date:
Approved By: LR/SW	Date:
Date Printed: August 7, 2020	

File Name: NTB-5252 - New Construction -details

Project Title
RECONSTRUCTION OF MAIN STREET (MUSKOKA ROAD 3)
Dwg. Title
LANDSCAPE DETAILS - 02

EXP Project No. NTB-00005252	DMM Contract No. 600-1-C-20
Dwg. No. L105	Rev. No. A